

The Heston IIC

4 Bed/Den opt./2.75 Bath
2,748 sq. ft.

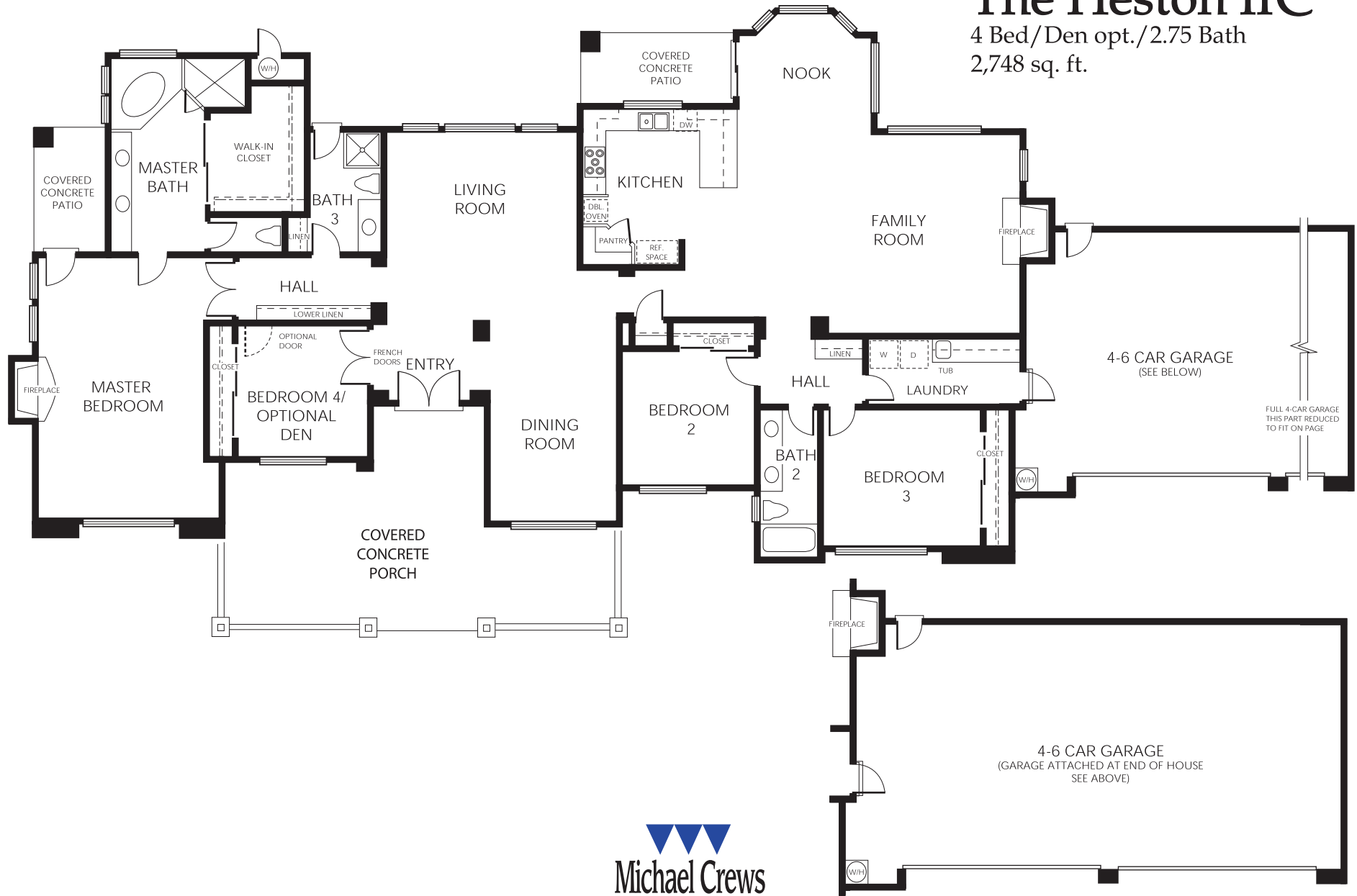

Room dimensions and square footage may vary. Michael Crews Development reserves the right at its sole discretion to make modifications to maps, floor plans, elevations, specifications, materials, features, and exterior colors without prior notice.



See Something New

(CREWS DEVELOPMENT) Heston IIC: 06/08/05